

# WP

## Угловые фланцевые резьбовые соединения

Группа изделий 5269

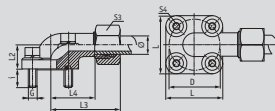

### Обозначение

| серия        | давление | Ø      | D  | L  | L2 | L3   | L4 | i    | G    | S3  | S4 |   |
|--------------|----------|--------|----|----|----|------|----|------|------|-----|----|---|
| WP 08 HL     | L        | PB 315 | 10 | 35 | 39 | 16,5 | 46 | 31   | 12,5 | M 6 | 19 | 5 |
| WP 10 HL     | L        | PB 315 | 12 | 35 | 39 | 16,5 | 46 | 31   | 12,5 | M 6 | 22 | 5 |
| WP 13 HL     | L        | PB 250 | 15 | 35 | 39 | 16,5 | 46 | 31   | 12,5 | M 6 | 27 | 5 |
| WP 13 HL 40  | L        | PB 100 | 15 | 40 | 42 | 22,5 | 46 | 31   | 12,5 | M 6 | 27 | 5 |
| WP 16 HL     | L        | PB 100 | 18 | 40 | 42 | 22,5 | 47 | 30,5 | 12,5 | M 6 | 32 | 5 |
| WP 20 HL     | L        | PB 100 | 22 | 40 | 42 | 22,5 | 47 | 30,5 | 12,5 | M 6 | 36 | 5 |
| WP 25 HL     | L        | PB 100 | 28 | 40 | 42 | 28   | 49 | 32,5 | 12,5 | M 6 | 41 | 5 |
| WP 32 HL     | L        | PB 100 | 35 | 40 | 42 | 32   | 52 | 30,5 | 12,5 | M 6 | 50 | 5 |
| WP 32 HL 55  | L        | PB 100 | 35 | 55 | 58 | 32   | 60 | 38,5 | 12,5 | M 8 | 50 | 6 |
| WP 40 HL     | L        | PB 100 | 42 | 55 | 58 | 40   | 61 | 38   | 12,5 | M 8 | 60 | 6 |
|              |          |        |    |    |    |      |    |      |      |     |    |   |
| WP 13 HS     | S        | PB 315 | 16 | 35 | 39 | 20   | 48 | 29,5 | 12,5 | M 6 | 30 | 5 |
| WP 16 HS     | S        | PB 315 | 20 | 35 | 39 | 25   | 56 | 34,5 | 12,5 | M 6 | 36 | 5 |
| WP 16 HS 40  | S        | PB 250 | 20 | 40 | 42 | 22,5 | 51 | 29,5 | 12,5 | M 6 | 36 | 5 |
| WP 16 HS 250 | S        | PB 250 | 20 | 55 | 58 | 24   | 56 | 34,5 | 12,5 | M 8 | 36 | 6 |
| WP 20 HS     | S        | PB 250 | 25 | 55 | 58 | 30   | 61 | 37   | 12,5 | M 8 | 46 | 6 |
| WP 25 HS     | S        | PB 250 | 30 | 55 | 58 | 32   | 62 | 35,5 | 12,5 | M 8 | 50 | 6 |

Серия: LL = простейшая – L = простая – S = сложная – Ø = наружный диаметр трубы – PN = номинальное давление – PB = макс. рабочее давление